



**GRAND**  
A V E N U E

U N W I N D & L U X U R Y

A Project by



Presenting



# GRAND AVENUE

Residential & Commercial

Walk into a world  
graced *with* luxury.

A sanctuary woven with choicest offerings to complement the needs and taste of those who have an eye for everything magnificent.



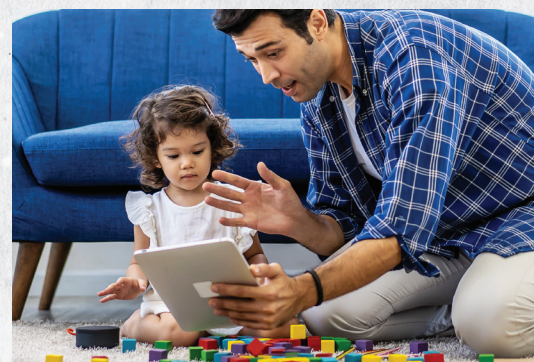

**GRAND  
AVENUE**

Residential & Commercial

# Seamless connectivity to all major destinations.

Nestled at a location that offers easy connectivity to all destinations nearby including the famous growing getaway spot – **Shirwal Market**

Located close to an urban hub, the project ensures everything you need is at a hand's distance.

- ♥ Hospital - 1 k.m.
- ♥ School - 0.8 k.m.
- ♥ Local Bazaar - 1 k.m.
- ♥ Police Station - 1 k.m.
- ♥ Bus Stop - 0.5 k.m.
- ♥ Banks - 0.9 k.m.





# Lifestyle to relish, grandeur to treasure.

A sight to behold, the elevation personifies finesse with a touch of innovative design. An aisle towards a world of top-notch luxuries, each 1 & 2 BHK abode here, is a fairytale waiting to be discovered.



**GRAND  
AVENUE**

Residential & Commercial

## Project Amenity & Facilities

### Residential

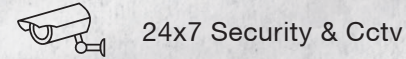

24x7 Security & Cctv



Stack Parking



Power Backup Automatic Lift



Security Cabin



Wifi Zone



Solar Panel Common Areas



24/7 Water Supply



Society Office



Walking Track

### Commercial Shops



24x7 Security & Cctv



Open Parking



Rooftop Restaurants



24/7 Water Supply For Shops



Common Toilet



## Project Specifications

### Structure -

- RCC Framed Earthquake Resistant Structure.
- 6" Thick External And 6" Internal Brick/AAC Block Wall.

### Flooring -

- 800 X 800 MM or Big Size Marble Finish Vitrified Tiles.

### Kitchen -

- Granite Kitchen Platform with Stainless Steel Sink with Drain Board.
- Glaze Designer/Ceramic Dado Tiles.
- Provision for Exhaust Fan.
- Concealed Plumbing.

### Doors -

- Laminated Main Door & Frame With Branded Fittings.
- Flush Door to all Rooms.
- Waterproof Doors to Toilets.

### Windows -

- M.S Safety Grills for Windows.
- Marble Seal Fitting.
- Mosquito Net for Window.

### Wall Finishes & Paints -

- OBD for Internal Walls.
- Acrylic Emulsion for External Walls.

### Toilets/Bathroom -

- Designer Glazed Tile on the Walls.
- Concealed Plumbing with Premium Quality Fittings.
- Sanitary Wear of Standard Brands.
- Anti Skid Ceramic Floor for Bath/toilets.
- Hot & Cold Mixing Unit in Bathroom.

### Electrical Fittings -

- Modular Switches.
- Concealed Multi Strand Fire Resistant Copper Wires with MCB & ELCB.
- Provision For AC Point in Master Bedroom.
- Television Point in Living Room

### Parking -

- Provision for 2 Individual Stack Parking.

### Water Supply -

- Water Supply Through Centralised UG Water Tank & Overhead Water Tank with standby pump.

### Elevator -

- Branded Elevator with ARD System.

# Reimagining modern architecture.

A fine blend of modern architecture and refined aesthetics,



**GRAND  
AVENUE**  
UNWIND & LUXURY

gateway that bridges the gap between your dream life and reality while offering a lifestyle that offers the best of everything.

Architecture By:



**sumit  
bagade**  
ARCHITECTS

M. Arch. S.A.

RCC

Consultant By:

Shreeram Kulkarni

legal

Advisor By:

Adv. Sunil Landage



2 BHK Master Layout

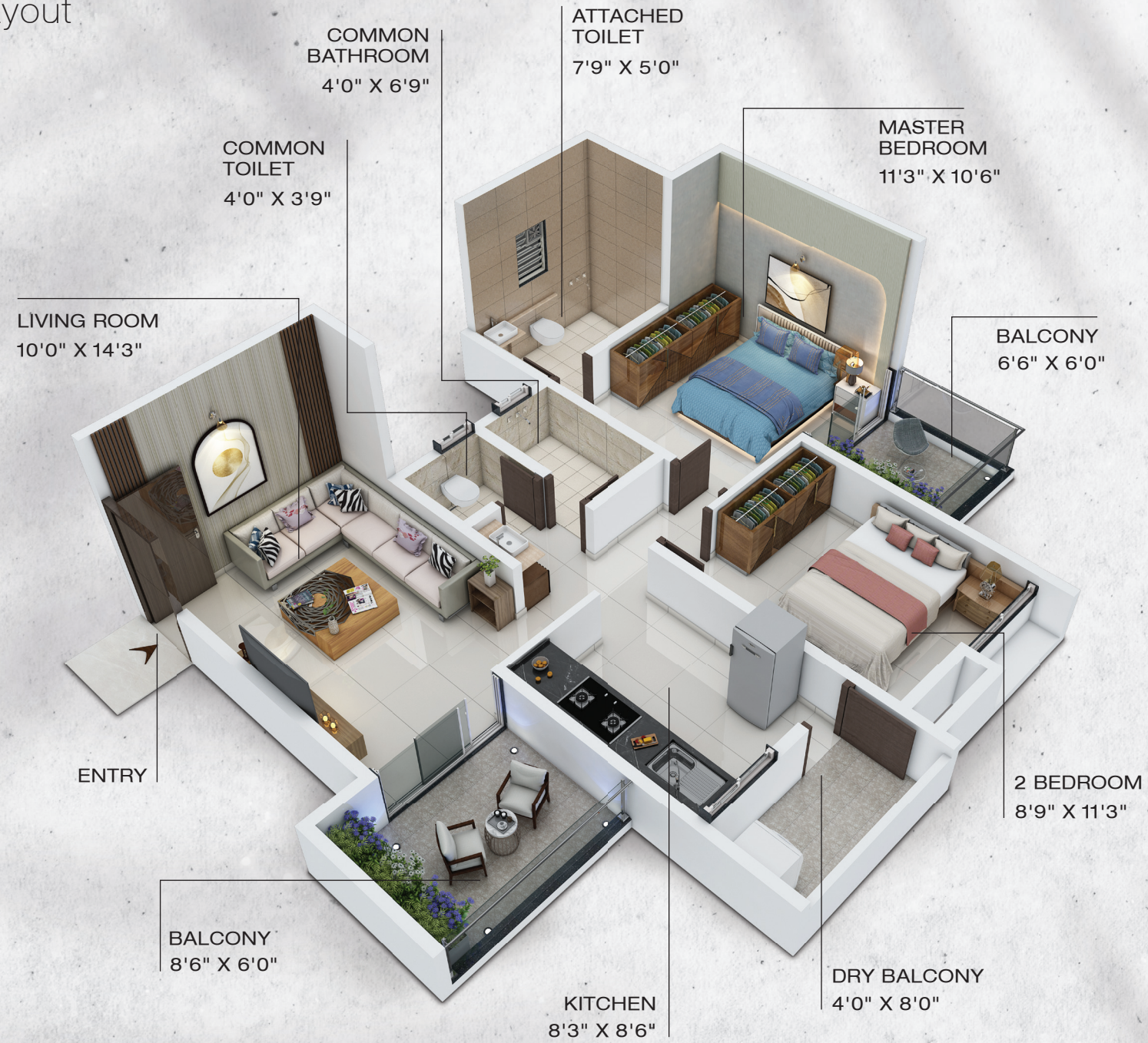

1 BHK Master Layout





Maharera No.  
P52700053570  
[www.maharera.mahaonline.gov.in](http://www.maharera.mahaonline.gov.in)



Member of  
**CREDAI**

Site address - Gat no. 495, Plot no. 2+3, At Opp. HDFC Bank Shirwal Branch,  
At - Shirwal Taluka - Khandala, District- Satara. Pin. 412801.

Call: **98811 35347 • 98222 76168 • 86553 35533**



Office Address - Office no. 1 to 7, First Floor, Gajanan plaza,  
Visawa Naka, Opp Visawa Maruti Mandir, Sadarbazar Satara. Pin. 415003.

Disclaimer: The photographs/artistic impressions contained herein are illustrative and used for indicative purpose only. This is purely conceptual and not legal offering. No warranty either expressly or impliedly given that the completed development of the project will comply in any degree with such artistic impression depicted herein. All specifications, amenities etc. of the unit/project shall be as per the final agreement to sell between the parties. Recipients are advised to use their discretion in relying on the information described/shown herein.

Design &  
Illustration by

*teen  
spirit*  
Baby

9619047822